

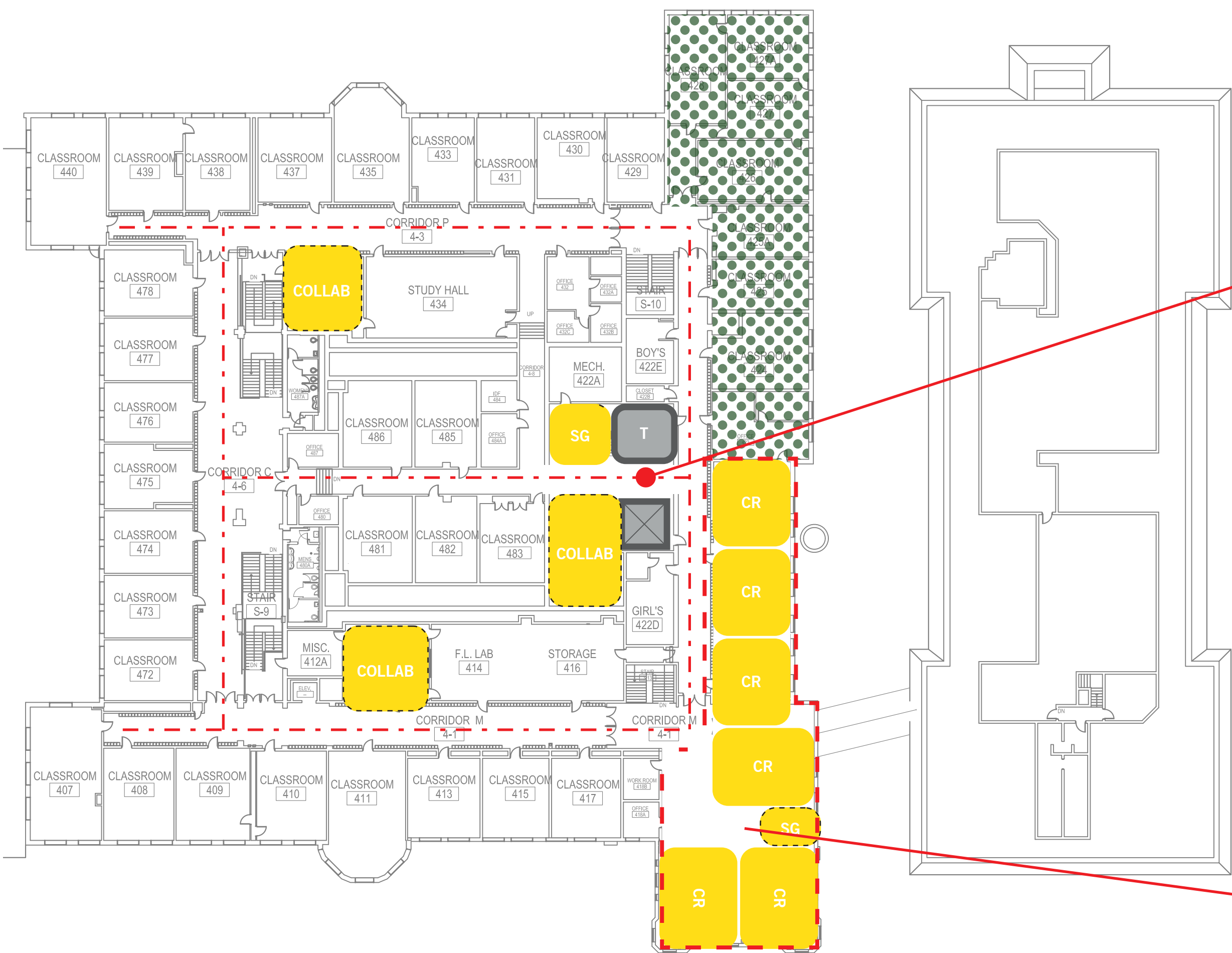

NORTH - GREY

4



Create corridor connection for improved wayfinding & observation

Reallocate former Applied Arts (FACS) labs for additional classroom space

Distributed Collaboration spaces provide areas for breakout and team teaching and project-based learning

Reallocate former Library space for additional classroom and collaboration space

3

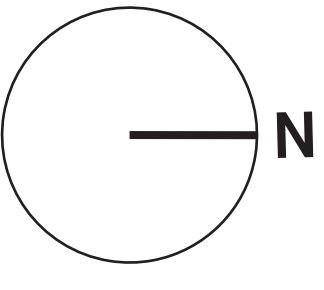

ABBREVIATIONS	
T	Toilet
CR	Classroom
CRIT	Critique Space
COLLAB	Collaboration Space
MECH	Mechanical Room
SM GR	Small Group
SPED	Special Education
STOR	Storage Room

LEGEND	
	Art: Visual
	Art: Performing
	Applied Arts
	English
	Science
	General/Shared Classrooms
	Mathematics
	World Languages
	History
	Special Education
	Library
	Physical Education
	Administration
	Community/Shared Spaces
	Building Services
	Dotted Hatch - Existing Program
	Solid Hatch - Proposed Program

2



Open corridor at end to provide way-finding improvements and connection to natural light

Relocate & update Math & Science classrooms to provide cross disciplinary collaboration opportunities

1



Relocate FACS labs to be adjacent to food services, loading facilities and entryway

New central elevator to improve accessibility

Consolidate & expand facilities for Special Education TEAM program



NORTH - PINK

4

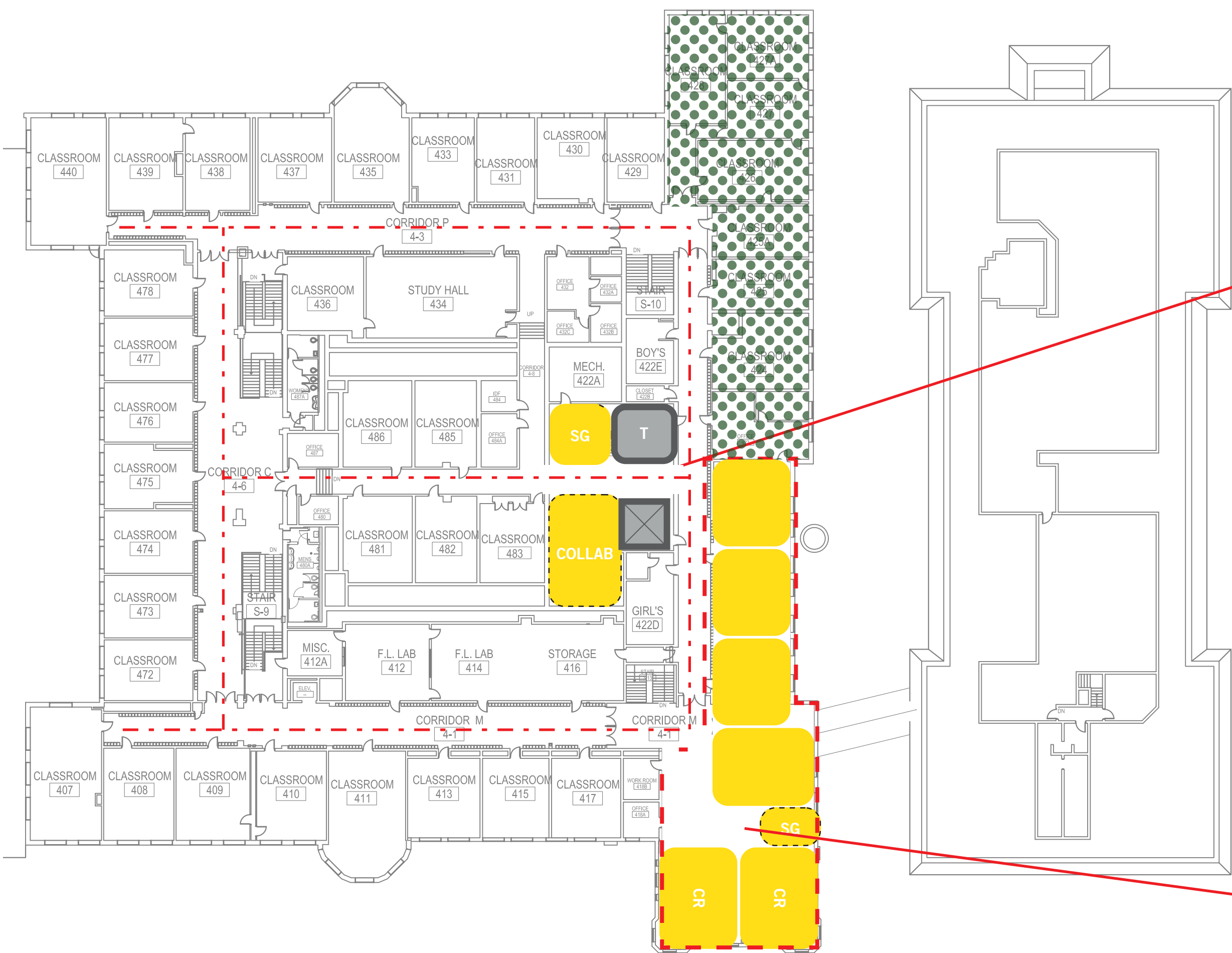

Create corridor connection for improved wayfinding & observation

Reallocate former Applied Arts (FACS) labs for additional classroom space

Reallocate former Library space for additional classroom and collaboration space

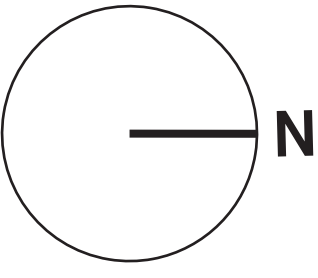

3



ABBREVIATIONS	
T	Toilet
CR	Classroom
CRIT	Critique Space
COLLAB	Collaboration Space
FACS	Family & Consumer Sciences
MECH	Mechanical Room
SM GR	Small Group
SPED	Special Education
STOR	Storage Room
LEGEND	
	Art: Visual
	Art: Performing
	Applied Arts
	English
	Science
	General/Shared Classrooms
	Mathematics
	World Languages
	History
	Special Education
	Library
	Physical Education
	Administration
	Community/Shared Spaces
	Building Services
	Dotted Hatch - Existing Program
	Solid Hatch - Proposed Program

Reallocate former Library space for additional classroom and collaboration space

2



Open corridor at end to provide way-finding improvements and connection to natural light

Relocate & update Math & Science classrooms to provide cross disciplinary collaboration opportunities

Provide central office space for Science & Math faculty for teaming & collaboration

1

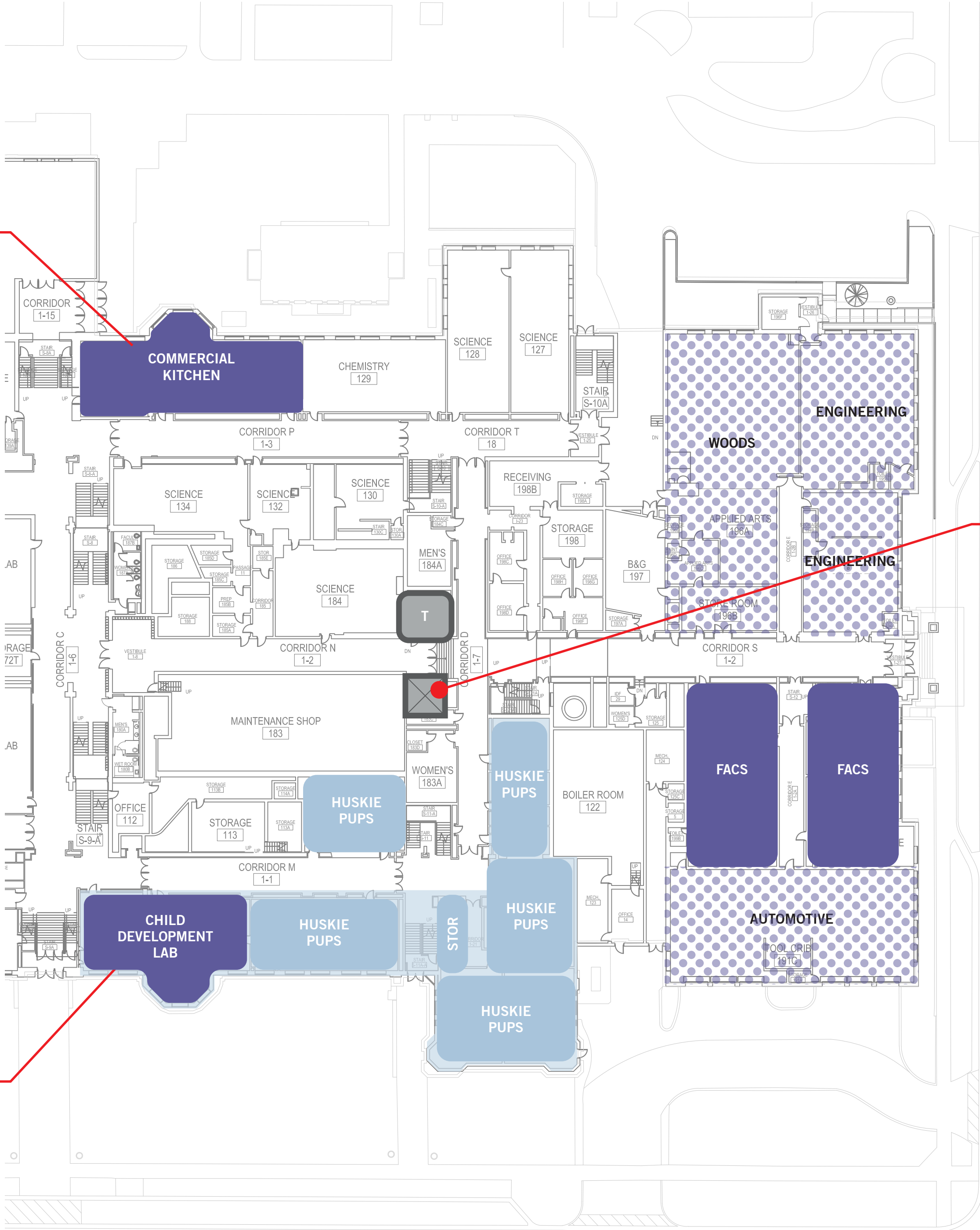

Relocate Commercial Kitchen to be adjacent to food services, loading facilities and entryway

New central elevator to improve accessibility

Consolidate Child Development and Huskie Pups programs near outside entrance

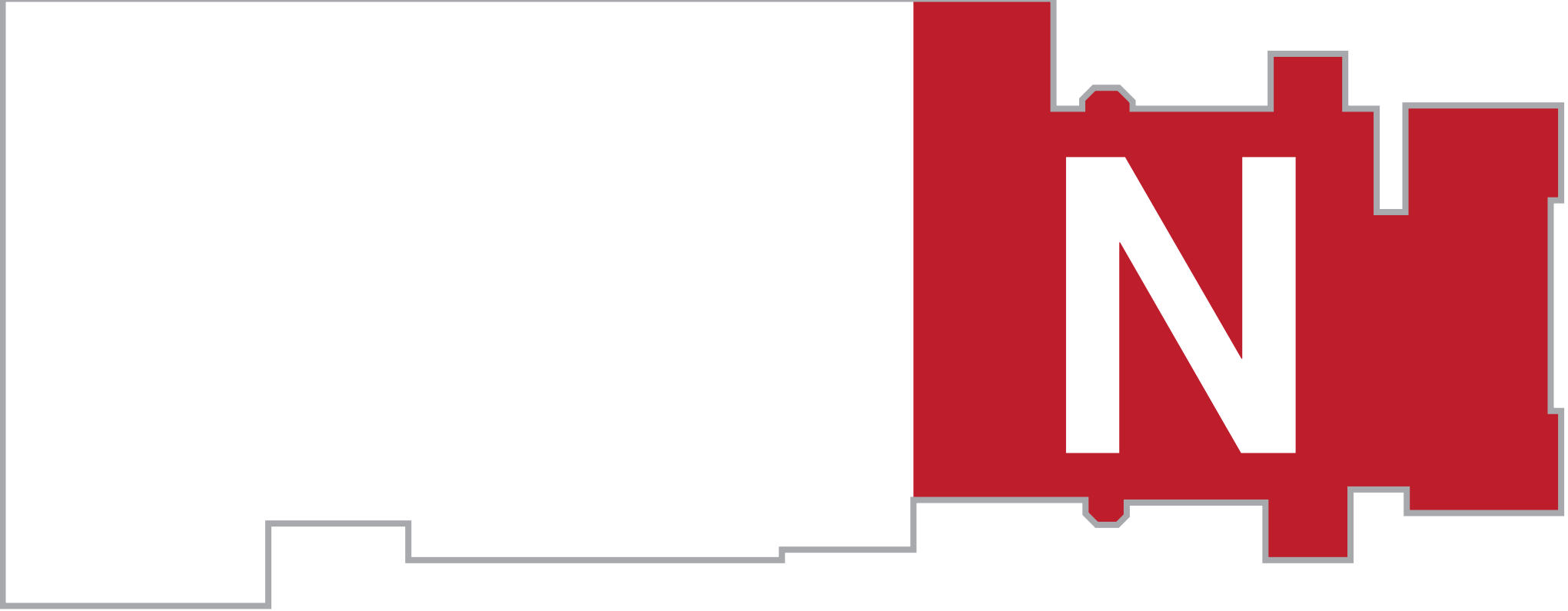

NORTH - RED

4

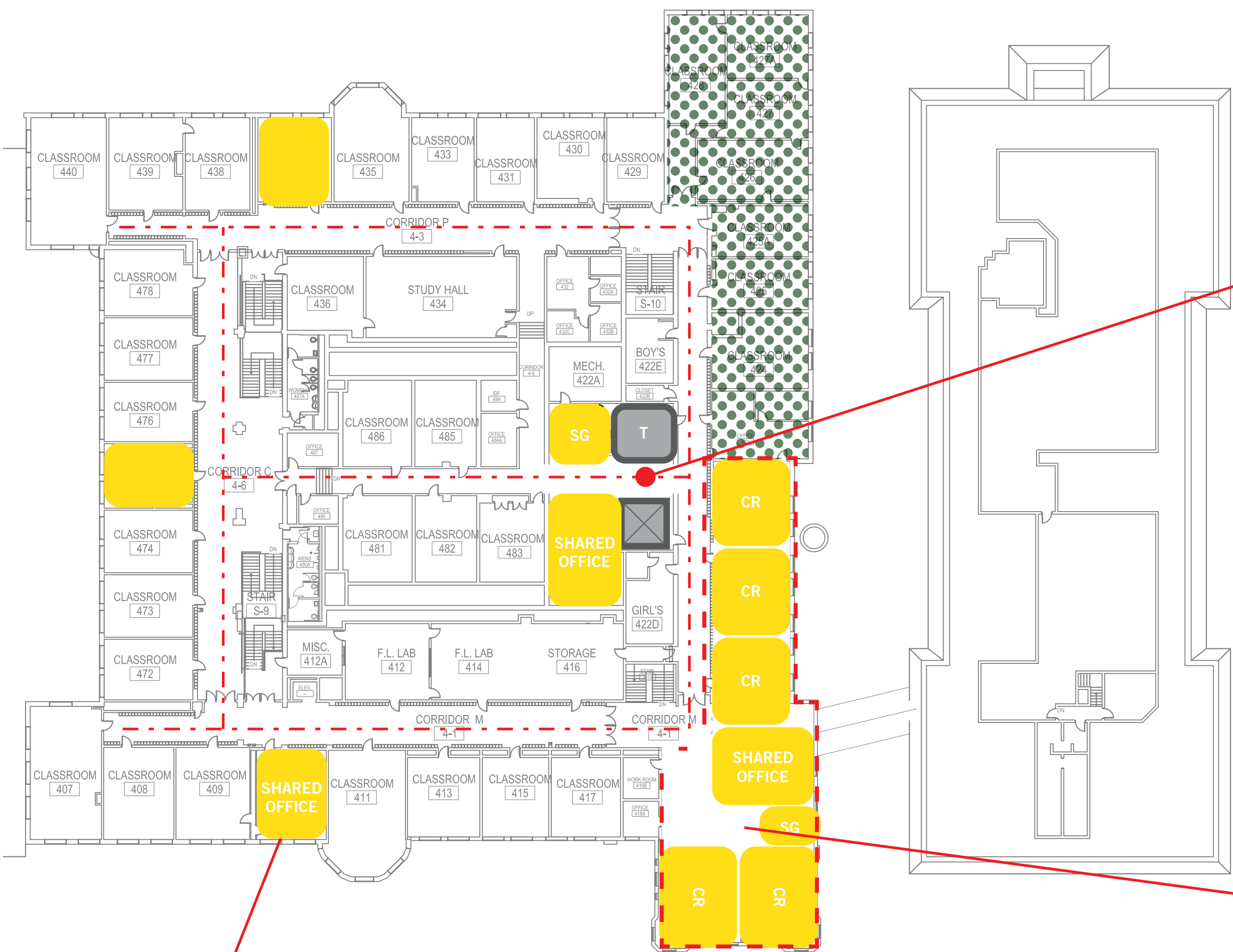

Create corridor connection for improved wayfinding & observation

Reallocate former Applied Arts (FACS) labs for additional classroom space

Distributed shared office spaces provide areas for cross-disciplinary collaboration

Reallocate former Library space for additional classroom and collaboration space

3

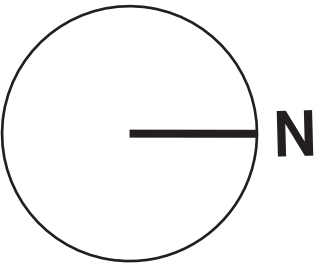

ABBREVIATIONS

- T Toilet
- CR Classroom
- CRIT Critique Space
- COLLAB Collaboration Space
- FACS Family & Consumer Sciences
- MECH Mechanical Room
- SM GR Small Group
- SPED Special Education
- STOR Storage Room

LEGEND

- Art: Visual
- Art: Performing
- Applied Arts
- English
- Science
- General/Shared Classrooms
- Mathematics
- World Languages
- History
- Special Education
- Library
- Physical Education
- Administration
- Community/Shared Spaces
- Building Services
- Dotted Hatch - Existing Program
- Solid Hatch - Proposed Program

2



Reallocate former Library space for additional classroom and collaboration space

Open corridor at end to provide way-finding improvements and connection to natural light

Relocate & update Math & Science classrooms to provide cross disciplinary collaboration opportunities

1

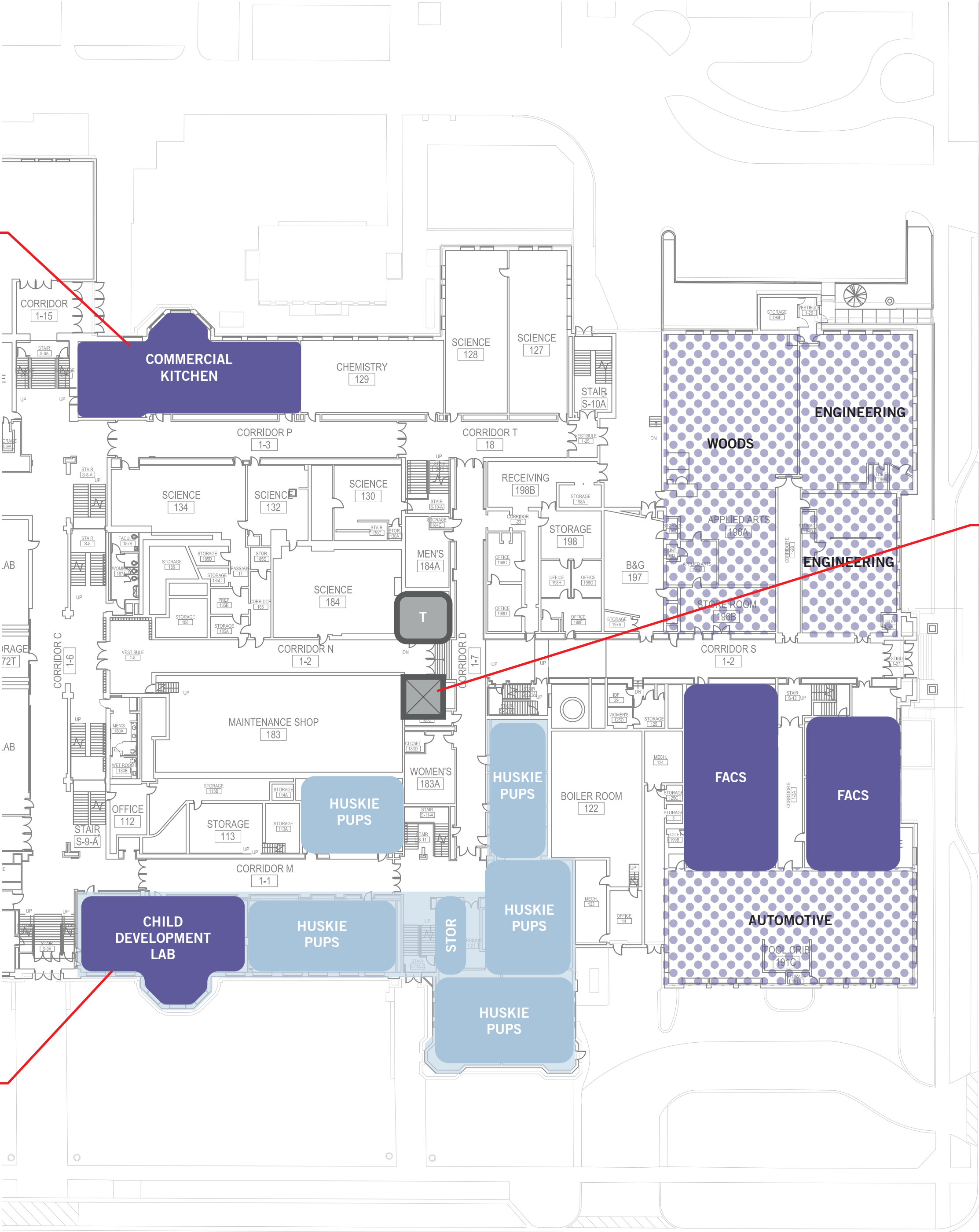

Relocate Commercial Kitchen to be adjacent to food services, loading facilities and entryway

New central elevator to improve accessibility

Consolidate Child Development and Huskie Pups programs near outside entrance