

Oak Park + River Forest High School

Long Term Facility Plan

Board Report May 17, 2016
3 Options, Summaries, and Cost



Oak Park and River Forest
High School

LEGATARCHITECTS
SUSTAINABILITY | PERFORMANCE | DESIGN

South End Option 1 - Summary Chart

Concept	Need or Opportunity	Dependencies	Space Gained/Benefits	Space Loss	2016 Cost*
Years 1-5					*add 3.5% per year for inflation
1. Renovate existing pools	Need: Warm/Safe/Dry		Additional water surface area	N/A	\$22,300,000
2. Expand Music	Need: Enrollment, future of learning	Moving indoor track off-site	Music department that can accommodate enrollment projections	160 Meter Indoor Track	\$5,457,375
3. Expand Music - Black Box Theatre Addition	Opportunity: Expand studio 200 below the driver's end addition	Addition	An ADA small performance space and can be used by students and the community	Green Space	\$1,959,375
4. Move Special Education on Site	Opportunity: Shared efficiencies	Expanding music in current 160 meter track space	On-site special education for students who have aged out	N/A	\$1,215,000
5. Driver's Ed Addition/PE Support	Opportunity: Currently separated from PE	Addition	Closer to other PE spaces	Green Space	\$1,781,250
6. Competition Gym	Need: Currently not existent, enrollment	Moving indoor track off-site	A true competition gym, with more seating	160 Meter Indoor Track	\$11,720,625
7. Update Student Locker Room Facilities	Need: Outdated, height of ceiling	Moving indoor track off-site	Updated locker space	160 Meter Indoor Track	\$4,242,700

Concept	Need or Opportunity	Dependencies	Space Gained/Benefits	Space Loss	2016 Cost*
Years 6-10					
8. Cafeteria and Kitchen Rebuild	Need: Enrollment, future of learning		Additional dining space	N/A	\$20,682,050
9. Stack Gyms Rebuild	Need: Enrollment		One PE station (a new gym)	N/A	\$13,365,000
10. Centralize Tutoring Center, Library, and Faculty Offices	Opportunity: Future of learning, capture vertical above cafeteria addition	Infilling the library with 8 classrooms	Shorter average travel distance to receive academic support	N/A	\$11,072,250
11. Renovate Library to have Science Labs and Classroom Space	Opportunity: Future of learning	Library + learning commons moving	The new classrooms have direct access to natural daylight and views	N/A	\$7,795,875
12. Consolidate Huskie Pups	Opportunity: Way-finding	Infilling the library with 5 labs	Way-finding, easier for children to be dropped off by their parents	N/A	\$1,316,700
13. Move Family and Consumer Sciences to First Floor	Opportunity: Shared efficiencies/adjacencies, welcomes community	Consolidating huskie pups	Larger FCS café, 4 classrooms, 2 offices	N/A	\$6,469,650

South End Option 1 - First Floor

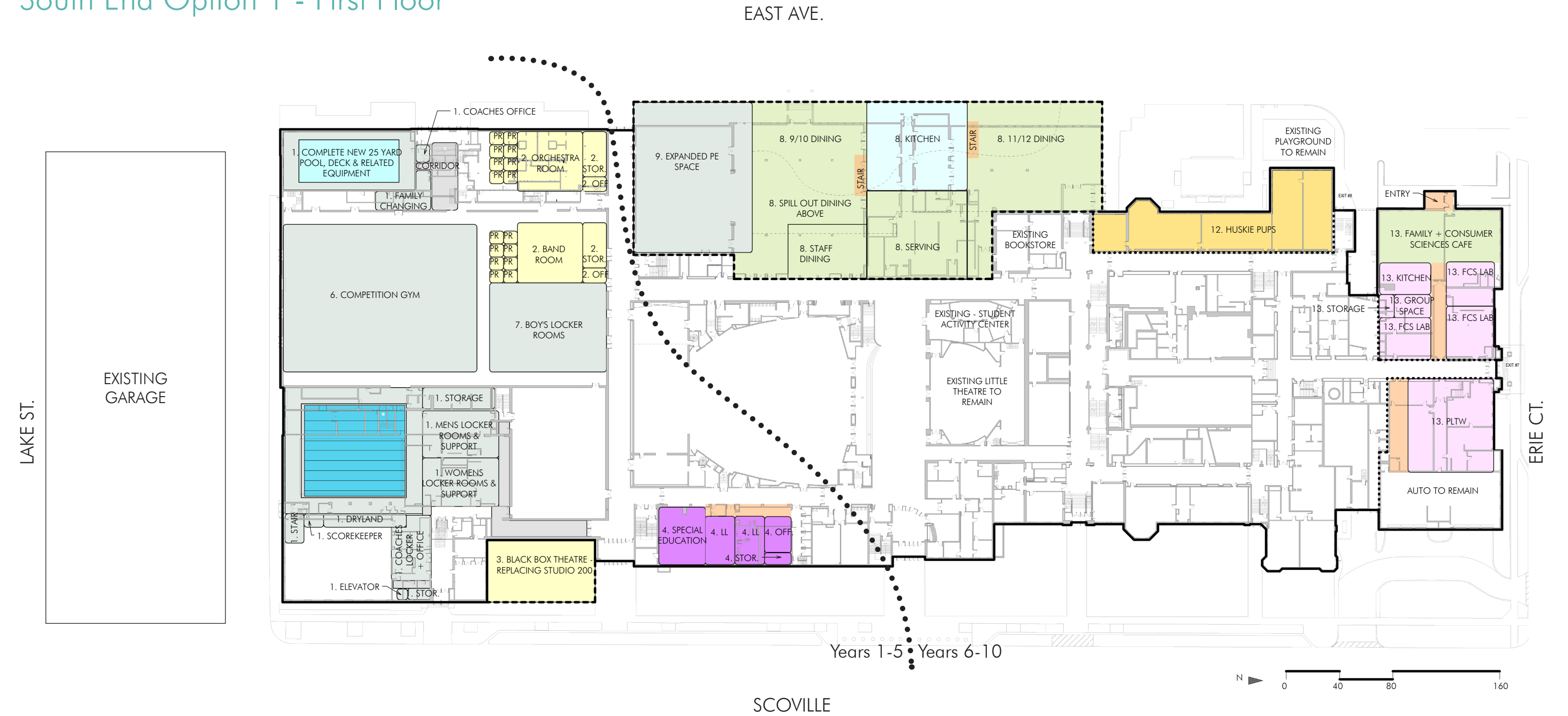

Circulation

Collaborative Node/Student Breakout Space

ATT

Attendance

FCS

Family and consumer sciences

LL

Learning Lab, ie flexible classroom space, combined with an office make up a Classroom Block.

OFF

Office space

PR

Practice Room

RC

Resource Center, a place for students to go to receive help, study, etc.

Applied Arts

Athletics

Classroom Space

Cafeteria

Huskie Pups

Office Space

Performing Arts

Resource (Teacher + Student)

Science

Special Education

Visual Arts

Welcome/Entry

Addition Perimeter

Existing Envelop Perimeter

Interior Renovations Perim

South End Option 1 - Second Floor

EAST AVE.



SCOVILLE

Years 1-5 • Years 6-10

- | | | | | | | | | |
|-------------|------------------------------|---|---|-----------------|--------------|------------------------------|-------------------|----------------------------------|
| Circulation | | Collaborative Node/Student Breakout Space | | Applied Arts | Cafeteria | Performing Arts | Special Education | --- Addition Perimeter |
| ATT | Attendance | LL | Learning Lab, ie flexible classroom space, combined with an office make up a Classroom Block. | Athletics | Huskie Pups | Resource (Teacher + Student) | Visual Arts | — Existing Envelop Perimeter |
| FCS | Family and consumer sciences | OFF | Office space | Classroom Space | Office Space | Science | Welcome/Entry | Interior Renovations Perim |
| | | PR | Practice Room | | | | | |
| | | RC | Resource Center, a place for students to go to receive help, study, etc. | | | | | |

South End Option 1 - Third Floor

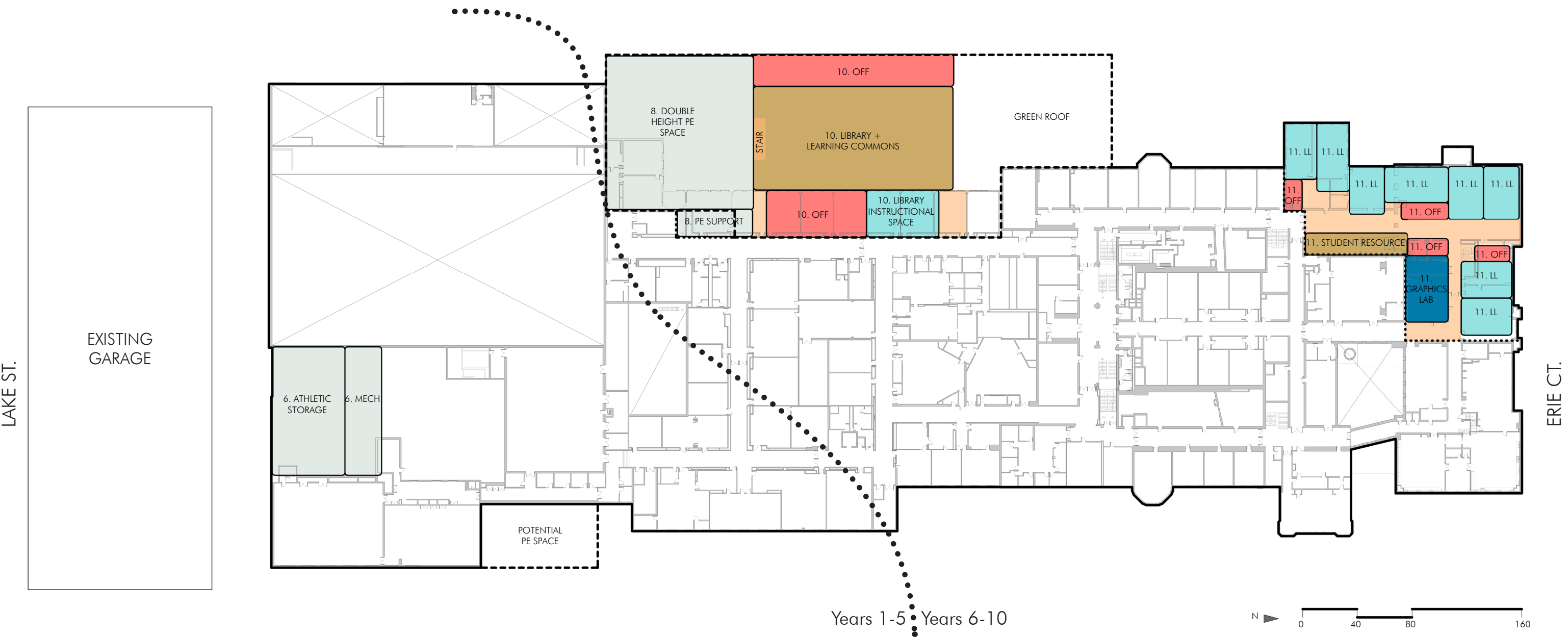

Circulation

Collaborative Node/Student Breakout Space

ATT

Attendance

FCS

Family and consumer sciences

LL

Learning Lab, ie flexible classroom space, combined with an office make up a Classroom Block.

OFF

Office space

PR

Practice Room

RC

Resource Center, a place for students to go to receive help, study, etc.

Applied Arts

Athletics

Classroom Space

Cafeteria

Huskie Pups

Office Space

Performing Arts

Resource (Teacher + Student)

Science

Special Education

Visual Arts

Welcome/Entry

Addition Perimeter

Existing Envelop Perimeter

Interior Renovations Perim

South End Option 1 - Fourth Floor

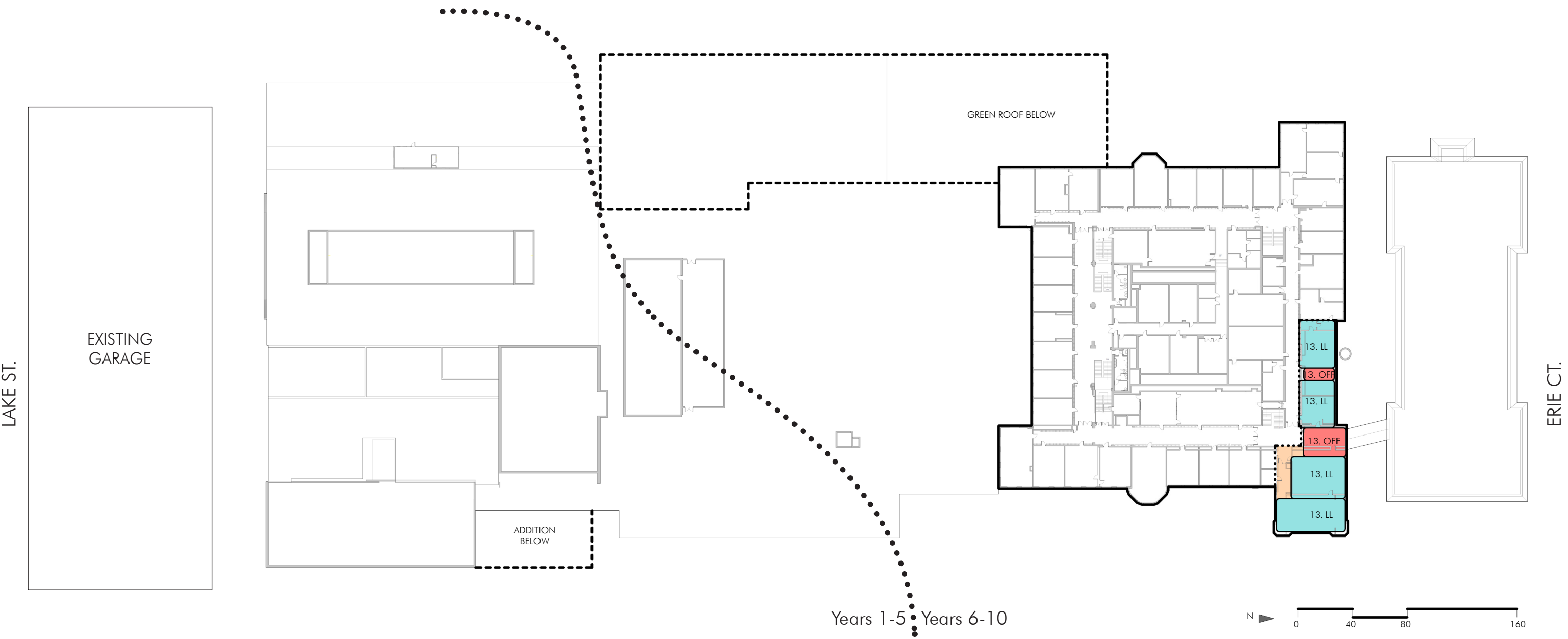

Circulation

ATT Attendance

FCS Family and consumer sciences

Collaborative Node/Student Breakout Space

LL Learning Lab, ie flexible classroom space, combined with an office make up a Classroom Block.

OFF Office space

PR Practice Room

RC Resource Center, a place for students to go to receive help, study, etc.

Applied Arts

Athletics

Classroom Space

Cafeteria

Huskie Pups

Office Space

Performing Arts

Resource (Teacher + Student)

Science

Special Education

Visual Arts

Welcome/Entry

--- Addition Perimeter

— Existing Envelop Perimeter

..... Interior Renovations Perim

Oak Park and River Forest High School | Legat Architects

6

South End Option 2 - Summary Chart

Concept	Need or Opportunity	Dependencies	Space Gained/Benefits	Space Loss	2016 Cost*
Years 1-5		*add 3.5% per year for inflation			
1. Natatorium and Parking Garage Addition	Need: Warm/Safe/Dry		A new natatorium/additional instructional space	N/A	\$42,100,000
2. Expand Music	Need: Enrollment, future of learning	Natatorium addition	Music department that can accommodate enrollment projections	N/A	\$5,754,375
3. Move Special Education on Site	Opportunity: Shared efficiencies	Expanding music in south end	On-site special education for students who have aged out	N/A	\$1,215,000
5. Update Student Locker Room Facilities	Need: Outdated, height of ceiling	Natatorium addition	Updated locker space	N/A	\$5,266,800

Concept	Need or Opportunity	Dependencies	Space Gained/Benefits	Space Loss	2016 Cost*
Years 6-10					
6. Cafeteria and Kitchen Rebuild	Need: Enrollment, future of learning		Additional dining space	N/A	\$20,682,050
7. Stack Gyms Rebuild	Need: Enrollment		One PE station (a new gym)	N/A	\$13,365,000
8. Centralize Tutoring Center, Library, and Faculty Offices	Opportunity: Future of learning, capture vertical above cafeteria addition	Infilling the library with 8 classrooms	Shorter average travel distance to receive academic support	N/A	\$11,072,250
9. Renovate Library to have Science Labs and Classroom Space	Opportunity: Future of learning	Library + learning commons moving	The new classrooms/labs have direct access to natural daylight and views	N/A	\$7,795,875
10. Consolidate Huskie Pups	Opportunity: Way-finding	Infilling the library with 5 labs	Way-finding, easier for children to be dropped off by their parents	N/A	\$1,316,700
11. Move Family and Consumer Sciences to First Floor	Opportunity: Shared efficiencies/adjacencies, welcomes community	Consolidating huskie pups	Larger FCS café, 4 classrooms, 2 offices	N/A	\$6,469,650
12. Expand Music - Black Box Theatre Replaces Lecture Halls	Opportunity: Expand studio 200 replacing lecture halls		A small student performance space	2 Lecture halls, 370/371	\$1,687,500

South End Option 2 - First Floor

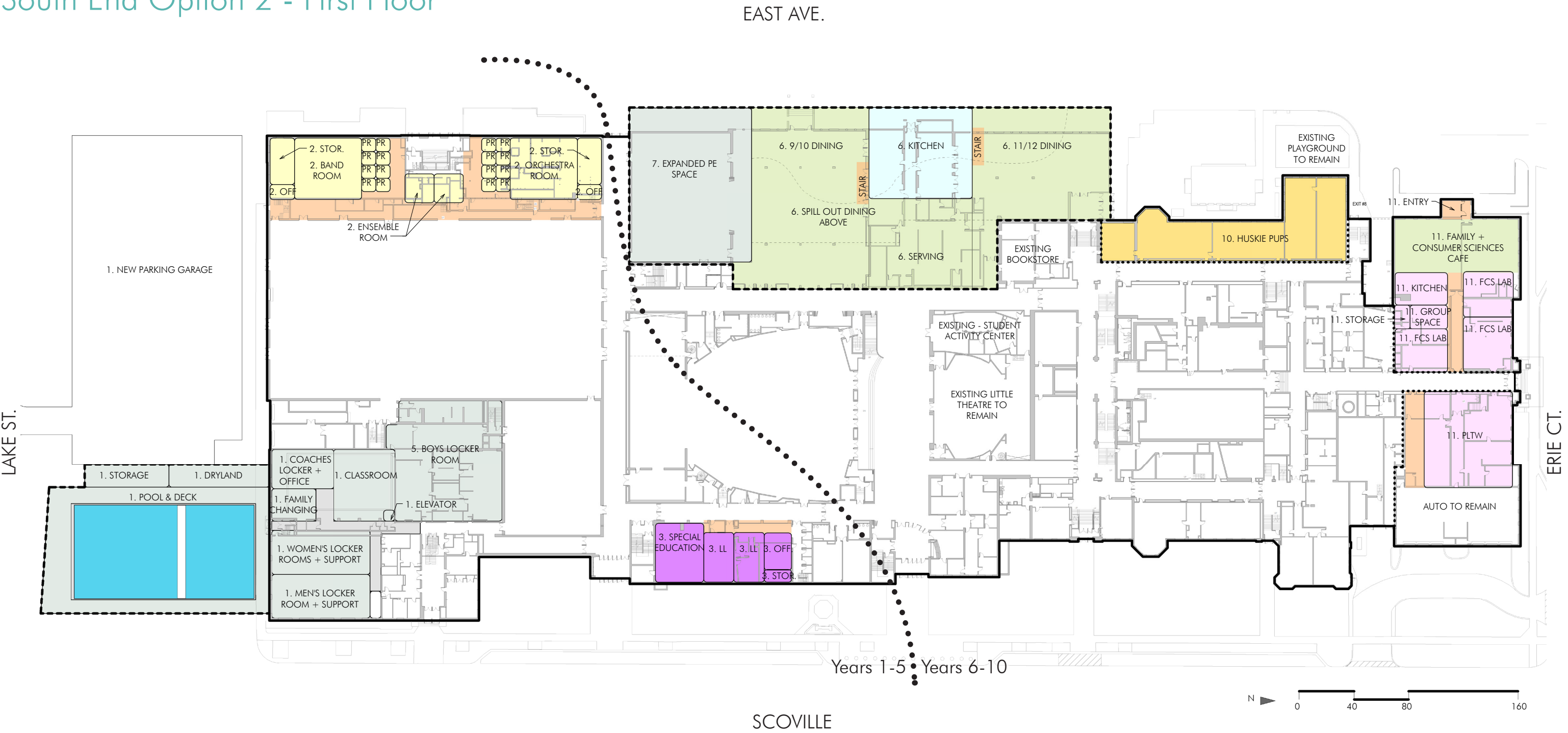

Circulation

Collaborative Node/Student Breakout Space

ATT

Attendance

FCS

Family and consumer sciences

LL

Learning Lab, ie flexible classroom space, combined with an office make up a Classroom Block.

OFF

Office space

PR

Practice Room

RC

Resource Center, a place for students to go to receive help, study, etc.

Applied Arts

Athletics

Classroom Space

Cafeteria

Huskie Pups

Office Space

Performing Arts

Resource (Teacher + Student)

Science

Special Education

Visual Arts

Welcome/Entry

Addition Perimeter

Existing Envelop Perimeter

Interior Renovations Perim

South End Option 2 - Second Floor

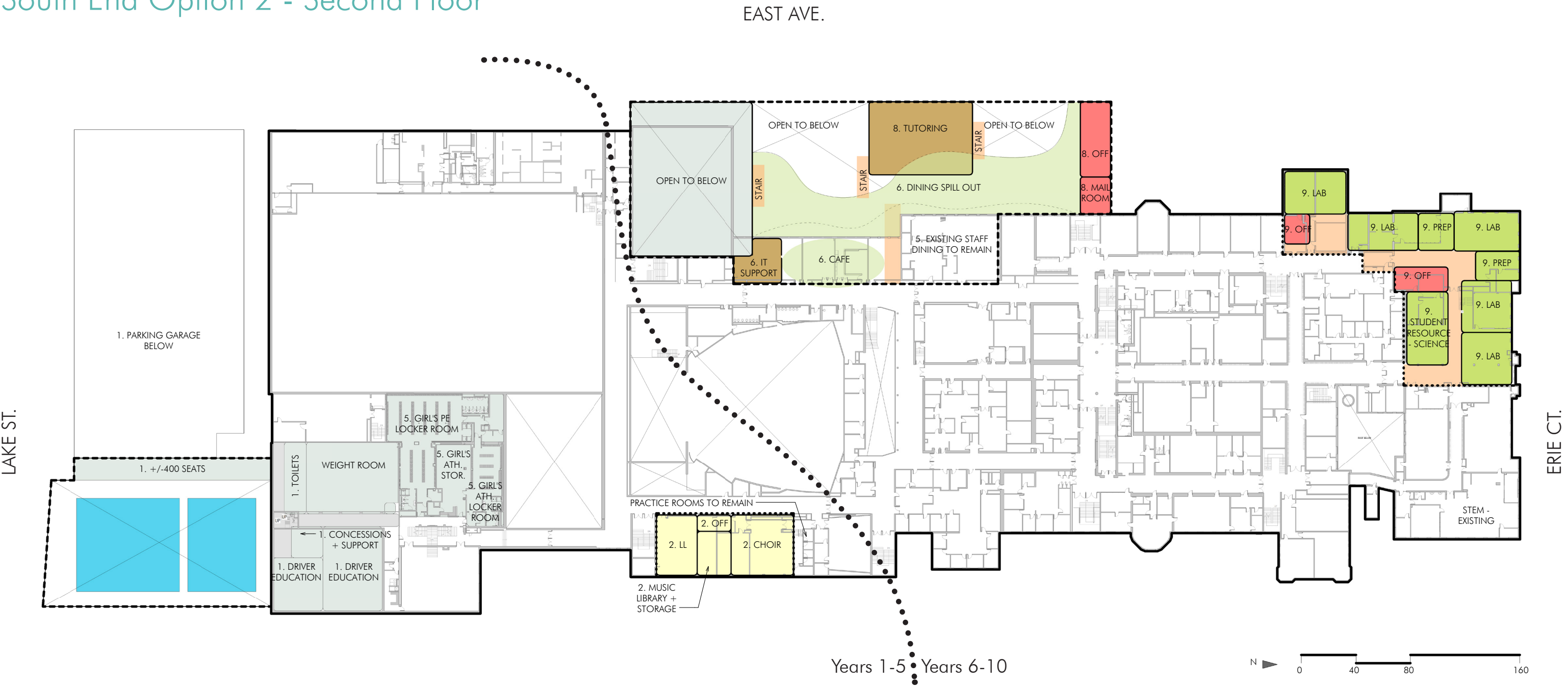

Circulation

Collaborative Node/Student Breakout Space

ATT Attendance

FCS Family and consumer sciences

LL Learning Lab, ie flexible classroom space, combined with an office make up a Classroom Block.

OFF Office space

PR Practice Room

RC Resource Center, a place for students to go to receive help, study, etc.

Applied Arts

Athletics

Classroom Space

Cafeteria

Huskie Pups

Office Space

Performing Arts

Resource (Teacher + Student)

Science

Special Education

Visual Arts

Welcome/Entry

--- Addition Perimeter

— Existing Envelop Perimeter

..... Interior Renovations Perim

Oak Park and River Forest High School | Legat Architects

9

South End Option 2 - Third Floor

EAST AVE.

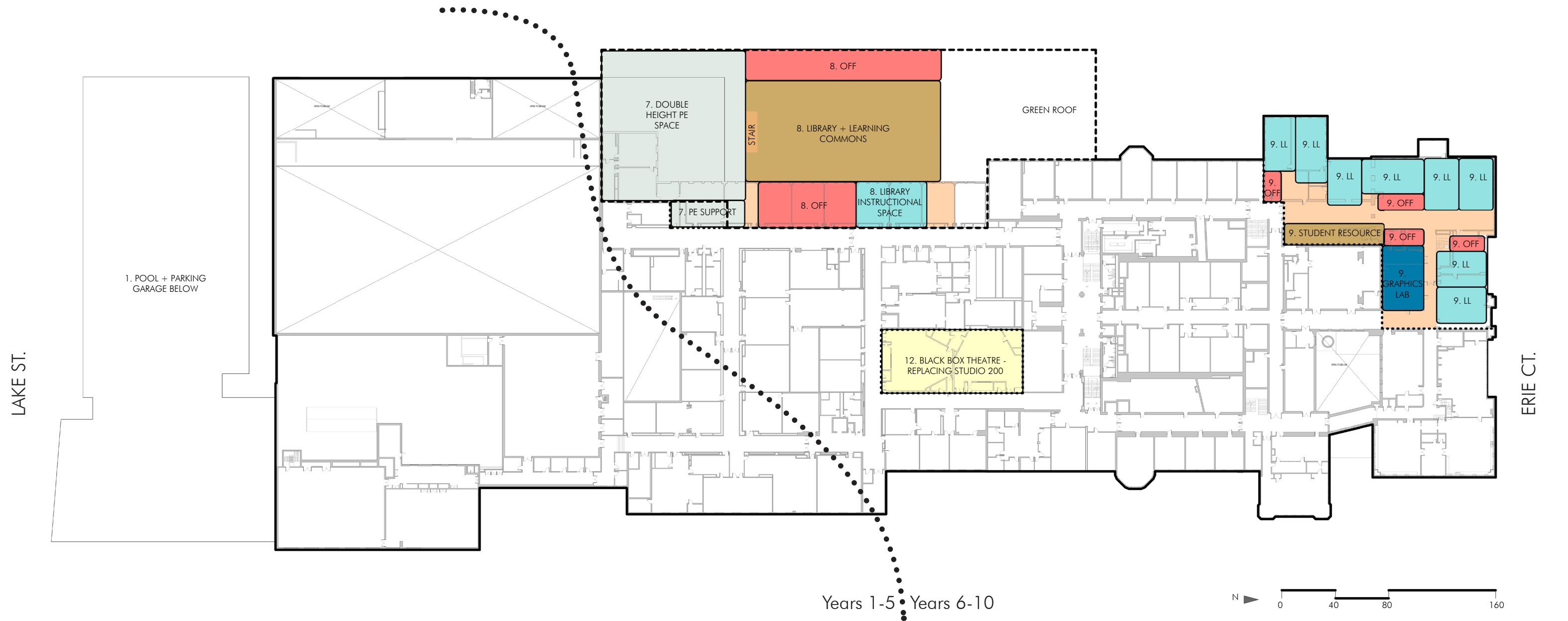

SCOVILLE

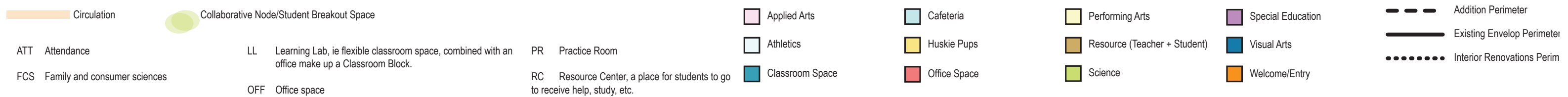

South End Option 2 - Fourth Floor

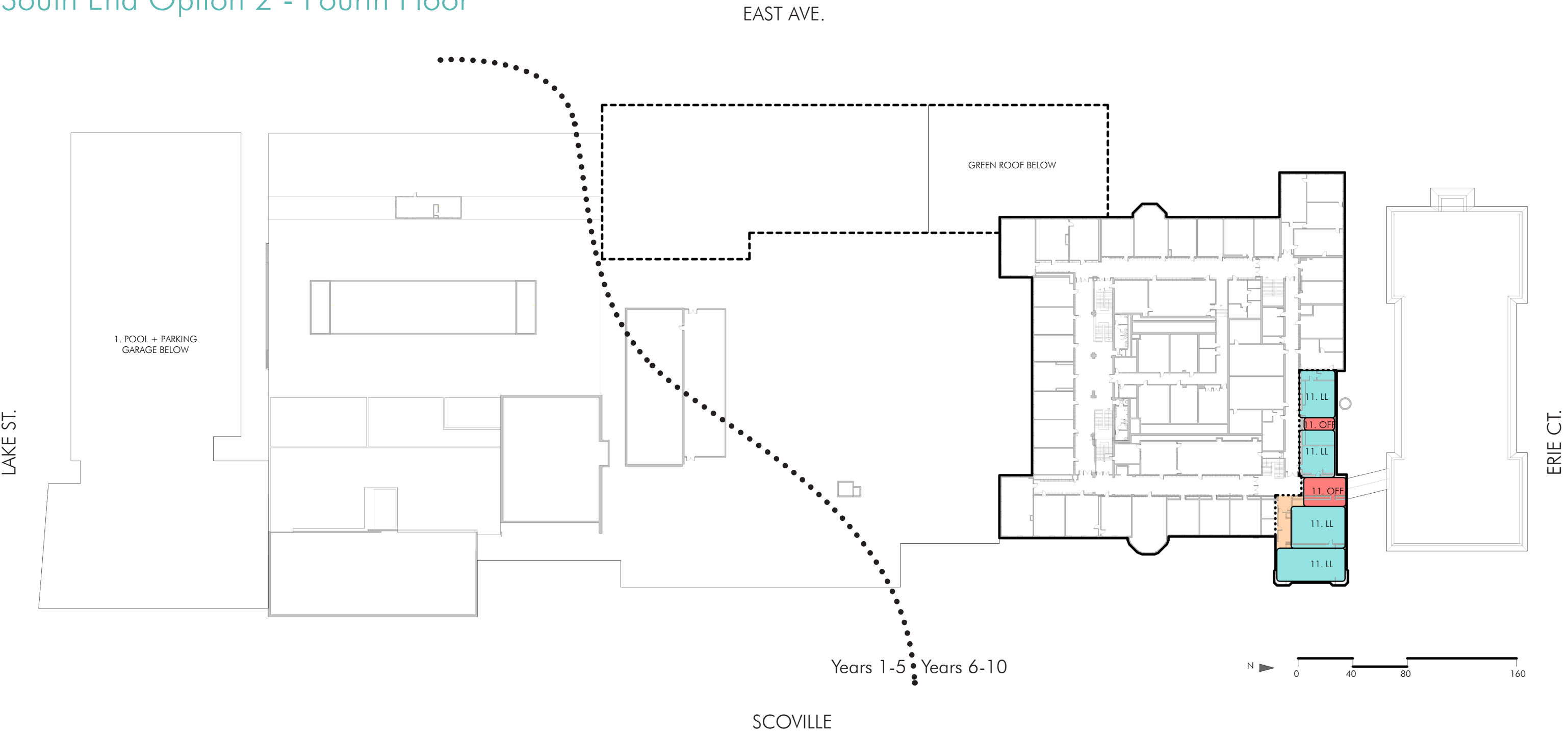

Circulation

ATT Attendance

FCS Family and consumer sciences

Collaborative Node/Student Breakout Space

LL Learning Lab, ie flexible classroom space, combined with an office make up a Classroom Block.

OFF Office space

PR Practice Room

RC Resource Center, a place for students to go to receive help, study, etc.

Applied Arts

Athletics

Classroom Space

Cafeteria

Huskie Pups

Office Space

Performing Arts

Resource (Teacher + Student)

Science

Special Education

Visual Arts

Welcome/Entry

--- Addition Perimeter

— Existing Envelop Perimeter

..... Interior Renovations Perim

South End Option 3 - Summary Chart

Concept	Need or Opportunity	Dependencies	Space Gained/Benefits	Space Loss	2016 Cost*
Years 1-5			*add 3.5% per year for inflation		
1. Natatorium	Need: Warm/Safe/Dry		A new 40-meter pool	N/A	Price included in 200 Meter Track Concept
2. Move Special Education on Site	Opportunity: Shared efficiencies	Expanding music in South End	On-site special education for students who have aged out	N/A	\$1,215,000
3. Expand Music	Need: Enrollment, future of learning	Natatorium Addition	Music department that can accommodate enrollment projections	N/A	Price included in 200 Meter Track Concept
3a. Expand Music - Black Box Theatre Addition	Opportunity: Expand studio 200 below the driver's end addition	Addition	A small student performance space	N/A	Price included in 200 Meter Track Concept
4. 200 Meter Track + New Gyms	Need: 200 Meter Track	Tear down south end and rebuild	200-meter track	*1 PE station	\$90,199,579

Concept	Need or Opportunity	Dependencies	Space Gained/Benefits	Space Loss	2016 Cost*
Years 6-10					
5. Cafeteria and Kitchen Rebuild	Need: Enrollment, future of learning		Additional dining space	N/A	\$20,682,050
6. Stack Gyms Rebuild	Need: Enrollment		*Replaces PE Station lost in the plan for Years 1 to 5	N/A	\$13,365,000
7. Centralize Tutoring Center, Library, and Faculty Offices	Opportunity: Future of learning, capture vertical above cafeteria addition	Infilling the library with 8 classrooms	Shorter average travel distance to receive academic support	N/A	\$11,072,250
8. Renovate Library to have Science Labs and Classroom Space	Opportunity: Future of learning	Library + learning commons moving	The new classrooms have direct access to natural daylight and views	N/A	\$7,795,875
9. Consolidate Huskie Pups	Opportunity: Way-finding	Infilling the library with 5 labs	Way-finding, easier for children to be dropped off by their parents	N/A	\$1,316,700
10. Move Family and Consumer Sciences to First Floor	Opportunity: Shared efficiencies/adjacencies, welcomes community	Consolidating huskie pups	Larger FCS café, 4 classrooms, 2 offices	N/A	\$6,469,650

South End Option 3 - First Floor

EAST AVE.

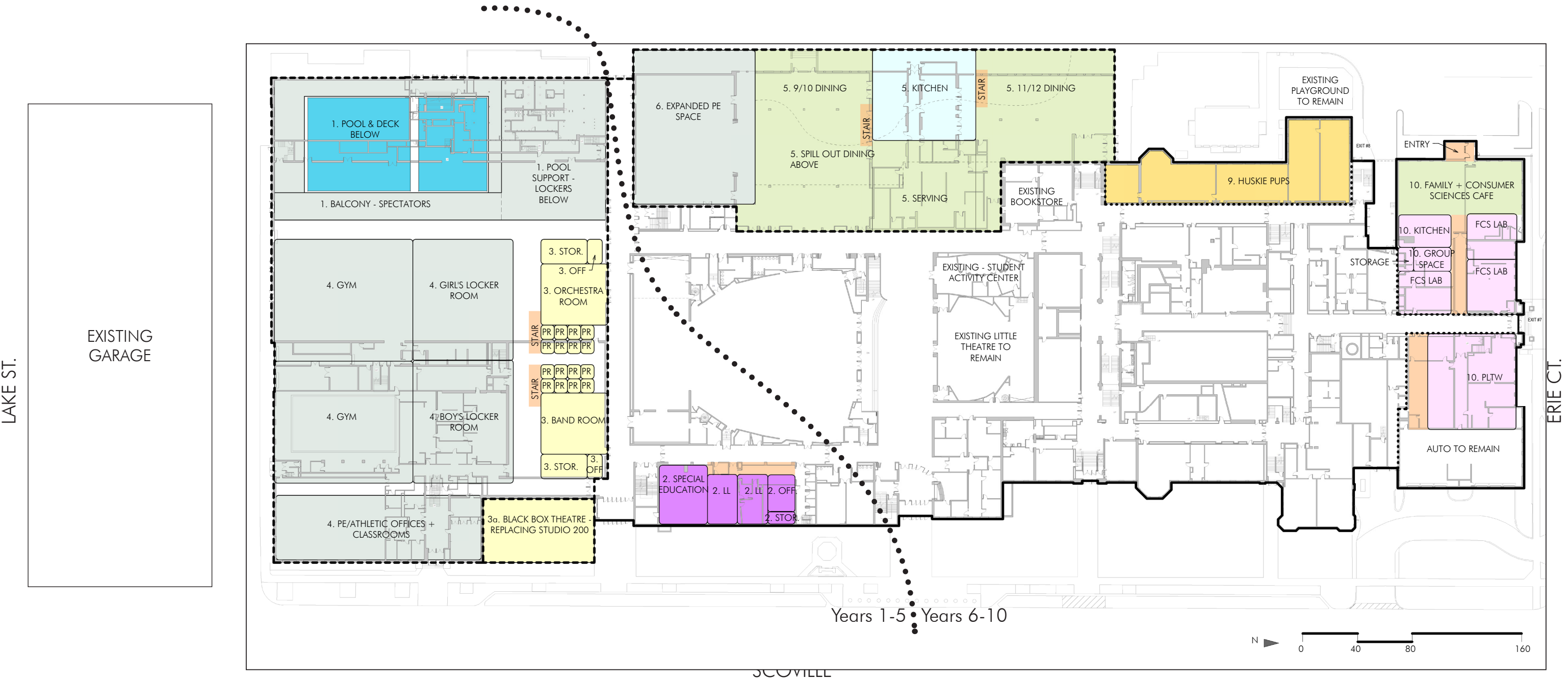

South End Option 3 - Second Floor

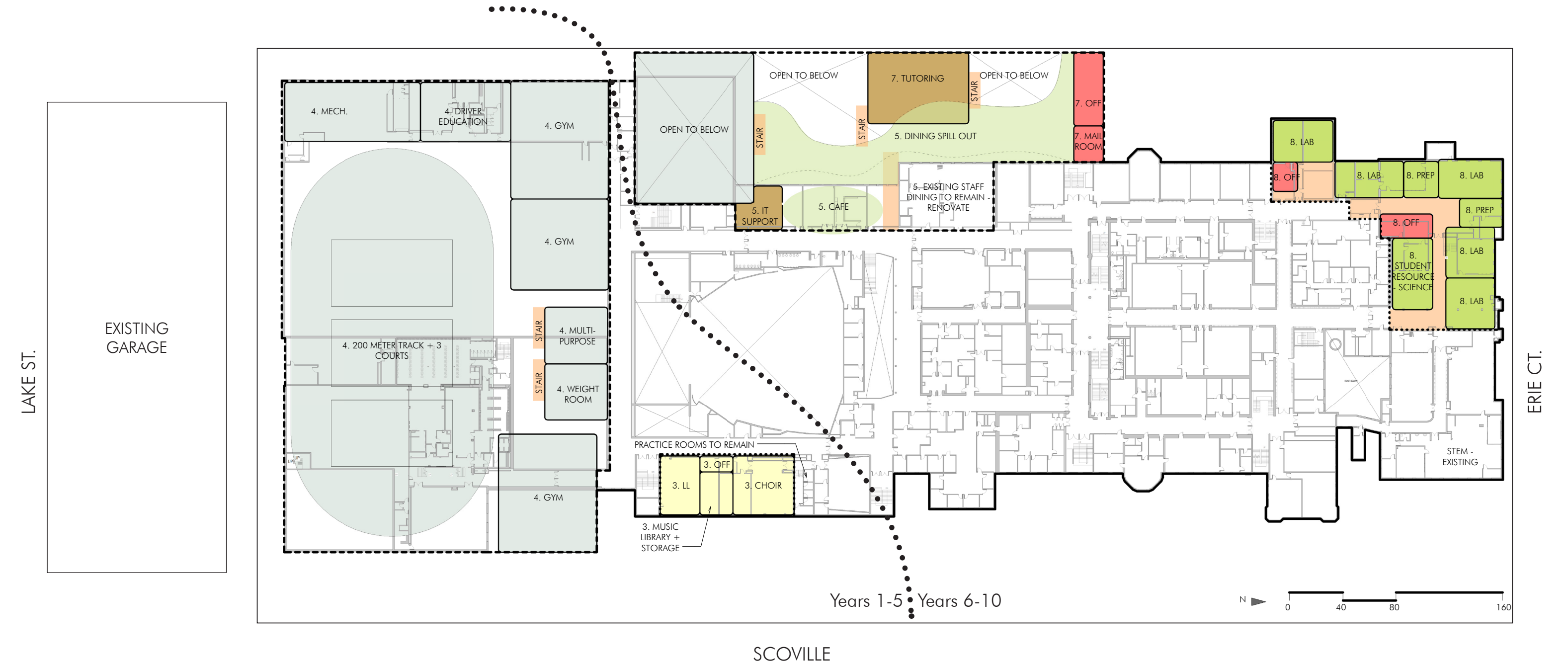

South End Option 3 - Third Floor

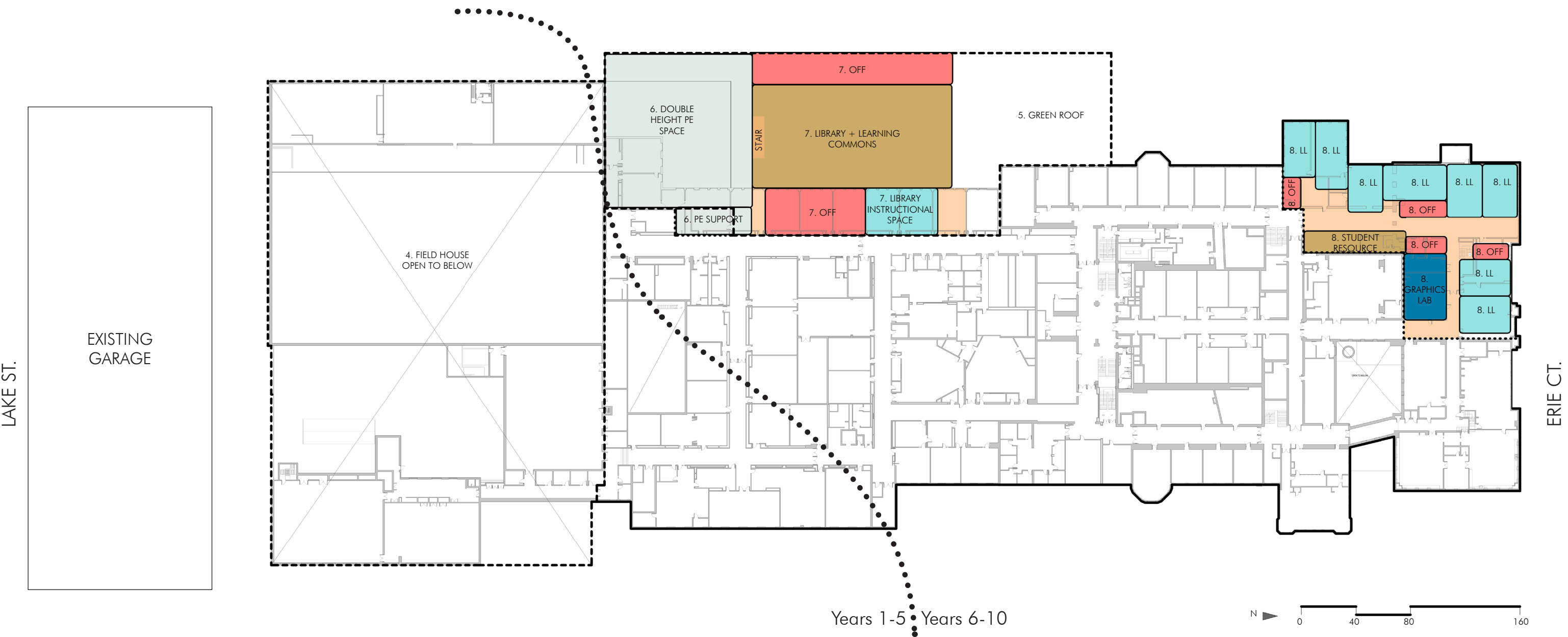

LAKE ST.

EXISTING GARAGE

EAST AVE.

SCOVILLE

ERIE CT.

Years 1-5

Years 6-10

Legend:

Circulation	Collaborative Node/Student Breakout Space	Applied Arts	Cafeteria	Performing Arts	Special Education	Addition Perimeter
ATT Attendance	LL Learning Lab, ie flexible classroom space, combined with an office make up a Classroom Block.	Athletics	Huskie Pups	Resource (Teacher + Student)	Visual Arts	Existing Envelop Perimeter
FCS Family and consumer sciences	OFF Office space	Classroom Space	Office Space	Science	Welcome/Entry	Interior Renovations Perim
		PR Practice Room				
		RC Resource Center, a place for students to go to receive help, study, etc.				

South End Option 3 - Fourth Floor

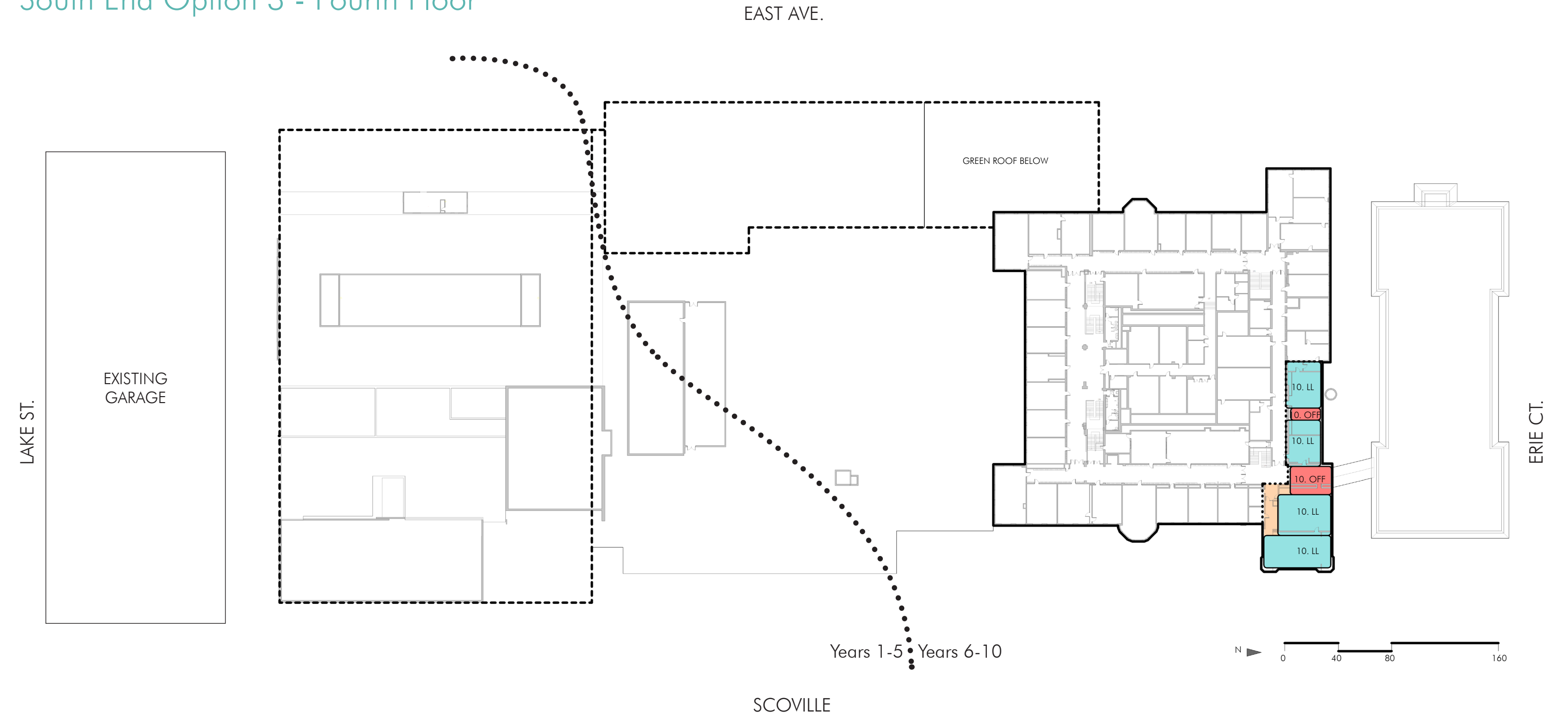

Circulation

ATT Attendance

FCS Family and consumer sciences

Collaborative Node/Student Breakout Space

LL Learning Lab, ie flexible classroom space, combined with an office make up a Classroom Block.

OFF Office space

PR Practice Room

RC Resource Center, a place for students to go to receive help, study, etc.

Applied Arts

Athletics

Classroom Space

Cafeteria

Huskie Pups

Office Space

Performing Arts

Resource (Teacher + Student)

Science

Special Education

Visual Arts

Welcome/Entry

--- Addition Perimeter

— Existing Envelop Perimeter

..... Interior Renovations Perim

Recommendations- Year 1

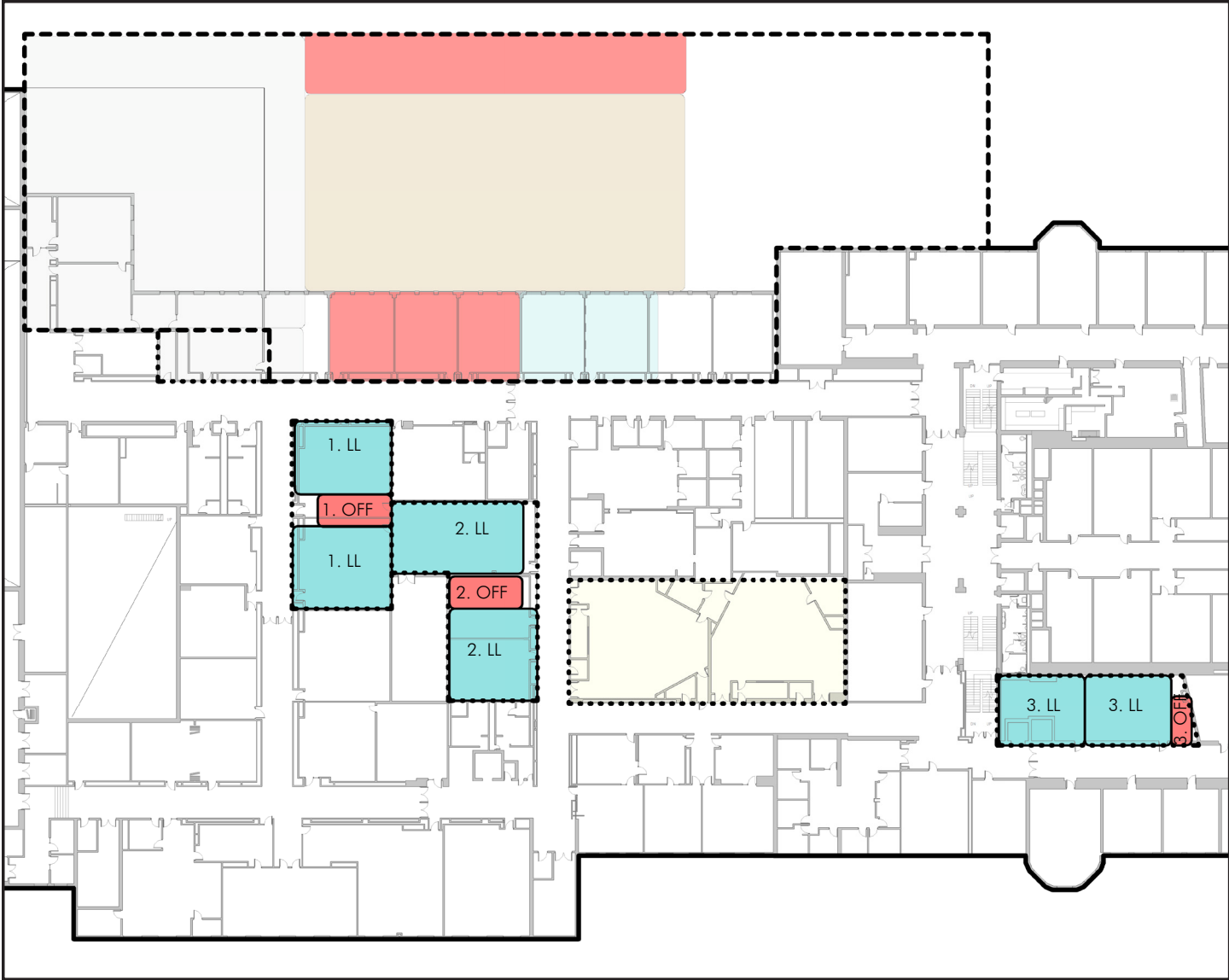

- Associated Costs:
- 1. \$570,000
 - 2. \$660,000
 - 3. \$350,000

Where the Design of Future Learning Environments can be Tested

